

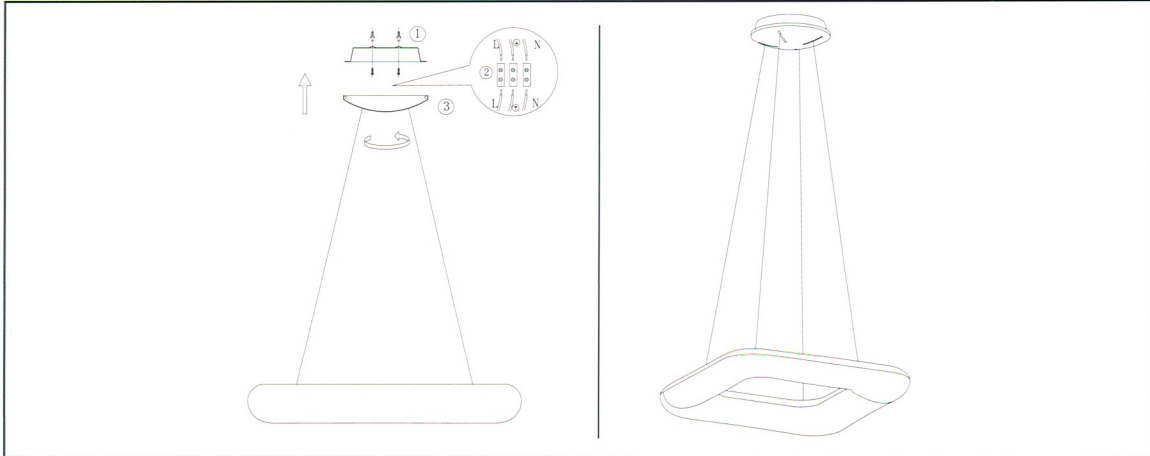

INNOVATIVE LED LIGHTING

INSTRUCTION MANUAL

MODEL:VT-7607



TECHNICAL PARAMETERS

- * With Color changing Dimmable function
- * Adjust Color temp from 3000K/4000K/5000K
- * With 2.4G Remote control for easy operation
- * Traic Dimming
- * AC Voltage: AC 220-240V. 50/60Hz
- * Material: Aluminum + PC lamp body
- * Protection Rating: IP20 (for Indoor use only)

INSTALLATION

Please insure the power is TURN OFF during Installation process.

- 1、 Fix the ceiling plate with screw.
- 2、 Fix the ceiling plate to the ceiling with screw.
- 3、 Then fix the ceiling base to the ceiling plate with screw accordingly.
- 4、 Turn on the lamp to check the light.

Attentions

Cut off the power before installation

The installation must be operated by professional technician.

Change the lamp shade in case if its broken

Cut off the power in case of abnormal performance and contact professional technician or local dealer.

Maintenance

Cleaning and checking the lamp on time for safety and better performance.

Cut off the power before cleaning.

* Suitable for 10-12Hours Daily, Usage of the product for 24Hours a Day would void the Warranty

- ▲ Operating frequency 2436.20 MHZ
- ▲ IP20 Ingress protection
- ▲ Class 3
- ▲ Remote control dimming with CCT model
- ▲ 3 years warranty



SPECIFICATION

No.	PARAMETER	TECHNIC GUIDELINE
1	Operating frequency	2436.20 MHZ
2	Frequency band	2436.20 +/- 0.03 MHZ
3	Transmit power	10 mW
4	Working voltage	1.8~3.6 VDC(Normal : 2X1.5VDC, AAA alkaline battery)
5	Modulation mode	MSK
6	Transmit speed	250Khz
7	Number of channels	1
8	Mode of operation	Simplex
9	Operating temperature	+5°C-+45°C
10	Cover color	WHITE
11	Operational life time	> 25,000 times
12	Noise level(dB)	≤25db at 30cm distance

MECHANICAL SPECIFICATIONS (UNIT: MM)

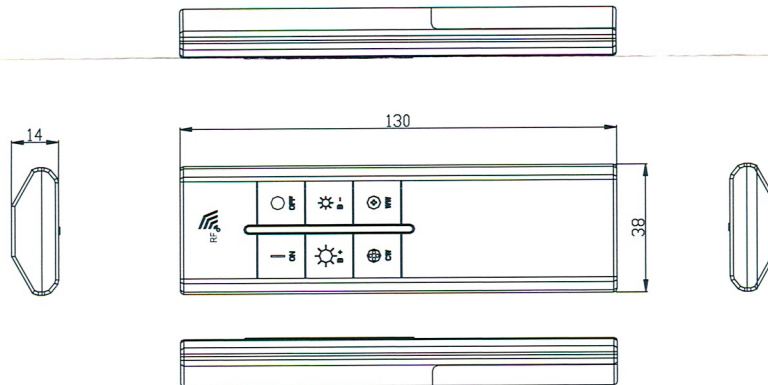

KEYS SPECIFICATION USER MANUAL

- 1—LED indicator. LED will flicker when you press any key.
- 2—ON/Pair. You can light the LED lamp by short -press this key. Pair the Remote controller and the LED driver by long- press this key within power on the driver 10s.
- 5—OFF/Unpair. You can close the LED lamp by short -press this key. Unpair the Remote controller and the LED driver by long- press this key within power on the driver 10s.
- 3/6—Brightness adjustment keys. You can increase the light brightness step by step by short-press the key 3 and less the brightness step by step by short-press key 6. Long-press the keys the brightness will change continuous.
- 4/7—color temperature adjustment keys. You can increase the cold white color and less the warm white color step by step by Short-press the key 4. Increase the warm white color and less the cold white color step by step by Short-press key 7. Long-press the keys the cold or warm white color will change continuous.

Note: ① long-press 2-3s, short-press less than 1s

② The LED lamps must be connecting positive pole together. The red output wires connect positive pole, the black output wires connect negative pole of the two channels of the LED lamp.

③ Pair or unpair the Remote Control and the LED driver. Long-press key 2 within 10s after turn on the LED lamp until the LED in the driver's PCB no flicker, the pair means OK. Long-press key 5 within 10s after turn on the LED lamp until the LED in the driver's PCB no flicker, the pair means cancel.

④ A LED driver (lamp) allows 2 remote controller to control at most, a remote controller can control lots of LED drivers (no limit of the numbers).

